

November 2018

Temporary traffic change on the Pacific Highway, Pimlico

Roads and Maritime Services, Pacific Complete and its contractor partners are working together to deliver the Woolgoolga to Ballina Pacific Highway upgrade.

The project team has almost completed work on new northbound lanes between Laws Road, Wardell and Pimlico Road, Pimlico. Traffic will be temporarily moved into these lanes from Tuesday 11 December, weather permitting.

We have included a map to show the location of this traffic change.

This new traffic arrangement is temporary and will allow us to maintain capacity on the road network while safely continuing to build new southbound lanes. The new pavement is permanent and will eventually be the northbound lanes of the upgraded highway.

How we manage our work

The project team will use machinery that generates noise, light and vibration. To manage this work, we will:

- Direct temporary lighting down and away from homes
- Locate equipment such as generators as far as possible from residences
- Turn off machinery when not in use
- Plan activities to minimise noise from reversing vehicles
- Monitor noise and implement further mitigation measures, if required.

All work will be carried out in line with the project's Conditions of Approval and Construction Environmental Management Plan.

Approved construction hours

Monday to Friday 7am–6pm

Saturday 8am–5pm



In areas where residents live more than 200 metres from the work, extended work hours are allowed between 6am and 7am and 6pm and 7pm from Monday to Friday. No work will be carried on Sunday or a public holiday.

Work outside of normal construction hours

To complete the temporary traffic change, work is required outside normal construction hours for technical reasons and is planned between 6pm and 7am for four nights from Monday 5 November, weather permitting.

Building next to, over and on existing roads means that traffic may be stopped or reduced to one lane while work is carried out. By working at night, delays are minimised and journey times for motorists are less affected.

For work that measures below five decibels at residential properties or if it is needed for technical reasons, the project team is only required to notify the community.

Traffic changes

To manage traffic queuing and safety, there will be a lane closure that may affect travel times. Please obey speed limits and follow the direction of traffic controllers and signs. Motorists are encouraged to remember PAC – Plan, Awareness, Caution. For the latest traffic updates, you can call 132 701, visit livetraffic.com or download the Live Traffic NSW app.

We apologise for any inconvenience and thank you for your patience during this important work.

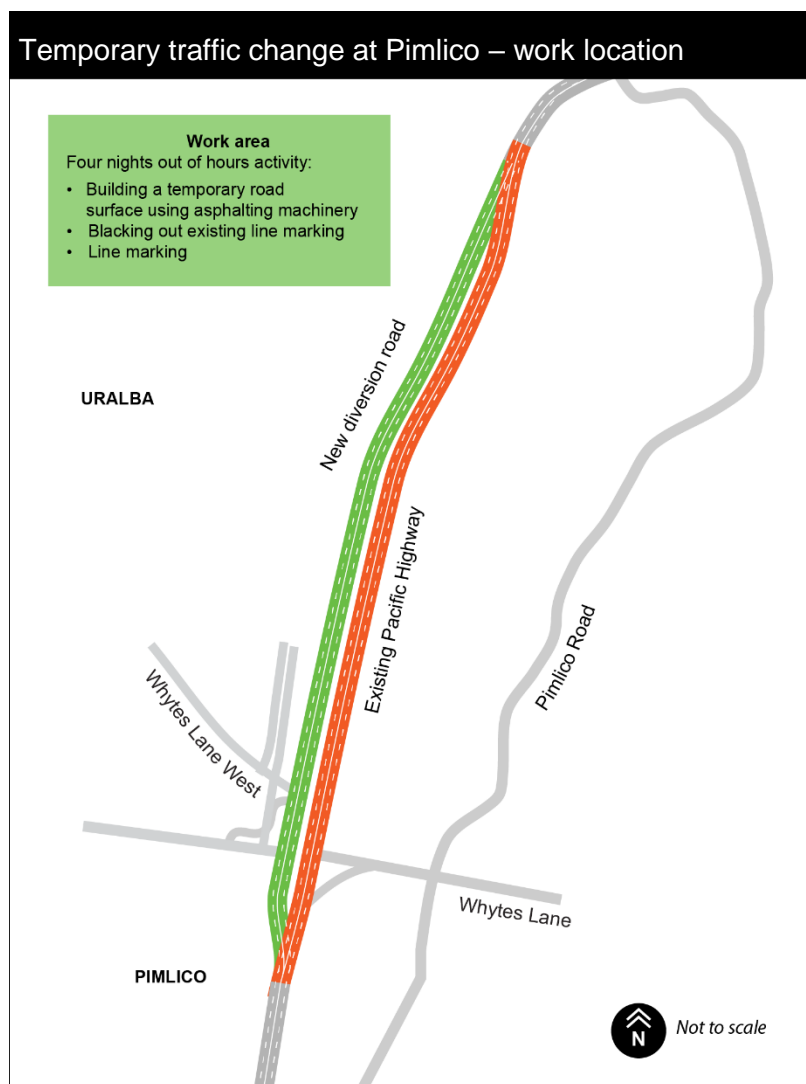

Subscribe now

We can keep you up to date about what's happening in your area or if you are interested in a specific topic. Register your interest:

☎ 1800 778 900 (toll free)

@ W2B@pacificcomplete.com.au

For more information

☎ 1800 778 900 (toll free)

@ W2B@pacificcomplete.com.au

🌐 pacifichighway.nsw.gov.au

f Follow NSW Roads

If you need help understanding this information, please contact the Translating and Interpreting Service on 131 450 and ask them to call us on 1800 778 900.

