

October 2019

Temporary traffic change at the intersection of Pimlico Road and Pacific Highway, Pimlico

Roads and Maritime Services, Pacific Complete and its contractor partners are working together to deliver the Woolgoolga to Ballina Pacific Highway upgrade.

As part of building the upgrade, the intersection of Pimlico Road and the Pacific Highway will be temporarily closed while asphaltting work is carried out on the highway. The temporary closure will be in place from Monday 14 October for up to four days between 6am and 6pm, weather permitting.

Motorists travelling to and from Pimlico Road will need to use the intersection of Whytes Lane and the Pacific Highway. Electronic message signs will be in place to keep motorists informed about timing for the closure.

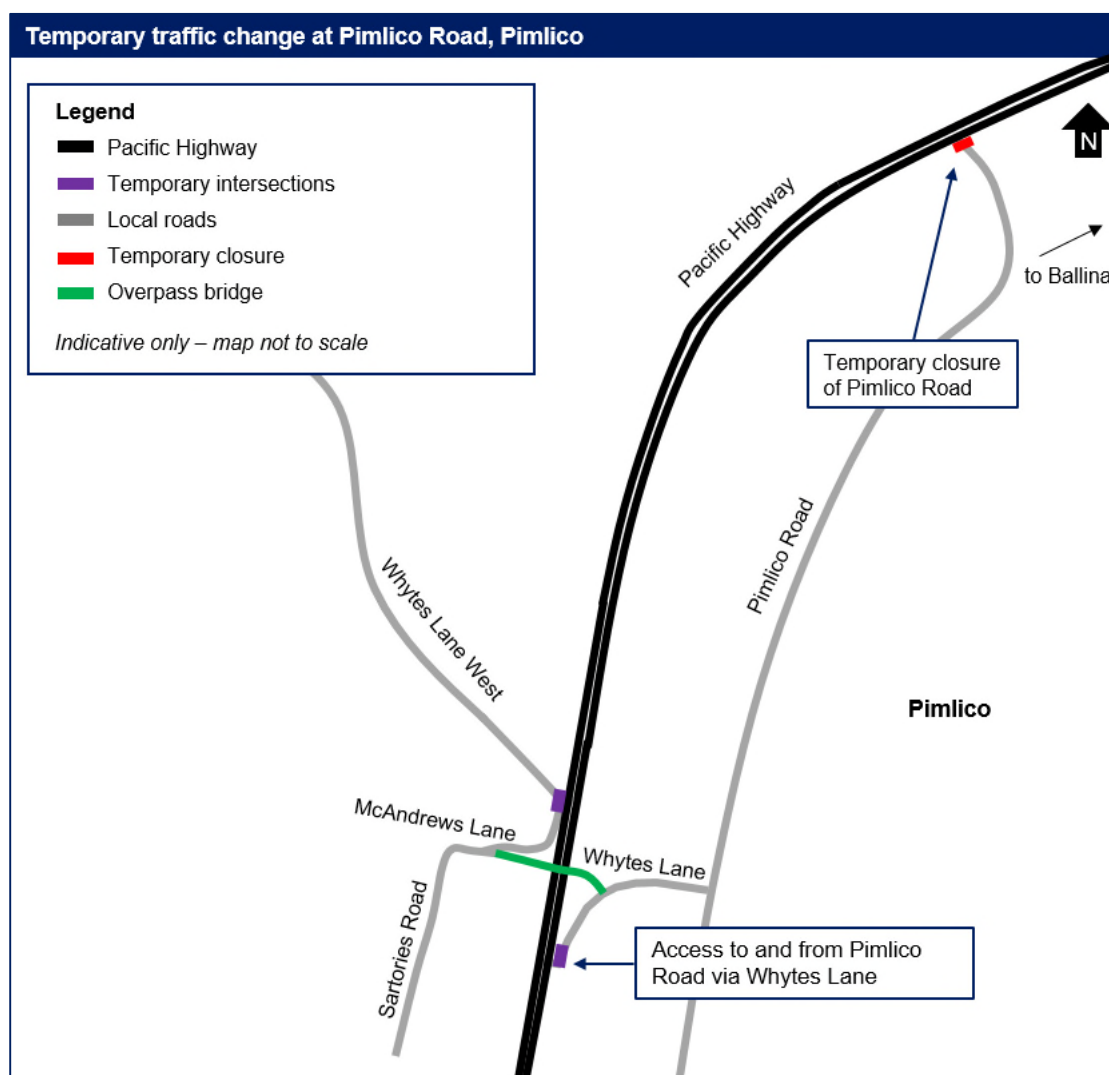

How we manage our work

The project team will use machinery that generates noise, light and vibration. To manage this work we will:

- turn-off machinery when not in use
- direct temporary lighting down and away from homes
- locate equipment such as generators as far as possible from residences
- plan activities to minimise noise from reversing vehicles
- monitor noise and implement further mitigation measures, if required

All work will be carried out in line with the project's Conditions of Approval and Construction Environmental Management Plan.

Work hours

Typically work will be carried out during the project's approved construction hours, which are:

Approved construction hours
Monday to Friday 7am–6pm
Saturday 8am–5pm





In areas where residents live more than 200 metres from the work, extended work hours are allowed between 6am and 7am and 6pm and 7pm from Monday to Friday. No work will be carried on Sunday or a public holiday.

Traffic changes

To manage queuing and safety, there will be some temporary traffic changes and lane closures that may affect travel times. Please keep to speed limits and follow the direction of traffic controllers and signs. Motorists are encouraged to remember PAC – Plan, Awareness, Caution. For the latest traffic updates, you can call 132 701, visit livetraffic.com or download the Live Traffic NSW app.

We apologise for any inconvenience and thank you for your patience during this important work.

Subscribe now	For more information
We can keep you up to date about what's happening in your area or if you are interested in a specific topic. Register your interest:	 1800 778 900 (toll free)
 1800 778 900 (toll free)	 W2B@pacificcomplete.com.au
 W2B@pacificcomplete.com.au	 pacifichighway.nsw.gov.au
	 Follow NSW Roads
If you need help understanding this information, please contact the Translating and Interpreting Service on 131 450 and ask them to call us on 1800 778 900.	

131 450